



SSC8039GT8

P-Channel Enhancement Mode MOSFET

➤ Features

V_{DS}	V_{GS}	$R_{DS(ON)}$	I_D
-30V	$\pm 20V$	12m Ω @-10V	-52A
		15m Ω @-4V5	

➤ Description

This device is P-Channel enhancement MOSFET. Uses advanced trench technology and design to provide excellent RDSON with low gate charge. This device is suitable for use in DC-DC conversion, power switch and charging circuit.

100% UIS + ΔV_{DS} + R_g Tested!

➤ Applications

- Motor Drive Control
- Portable Devices
- DCDC Conversion
- Power Supplies
- Synchronous Rectification

➤ Ordering Information

Device	Package	Shipping
SSC8039GT8	TO-252-2L	2500/Reel

➤ Pin Configuration

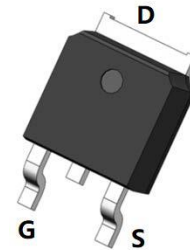

TO-252-2L (Top View)

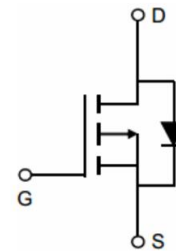

Pin Configuration

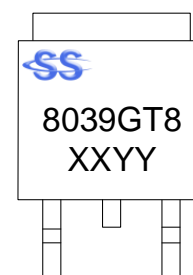

Marking

(XXYY: Internal Traceability Code)

**➤ Absolute Maximum Ratings ($T_A=25^{\circ}\text{C}$ unless otherwise noted)**

Symbol	Parameter	Ratings	Unit
V_{DSS}	Drain-to-Source Voltage	-30	V
V_{GSS}	Gate-to-Source Voltage	± 20	V
I_{D}	Continuous Drain Current ^d	$T_{\text{C}}=25^{\circ}\text{C}$	A
		$T_{\text{C}}=100^{\circ}\text{C}$	
I_{DSM}	Continuous Drain Current ^a	$T_{\text{A}}=25^{\circ}\text{C}$	A
		$T_{\text{A}}=70^{\circ}\text{C}$	
I_{DM}	Pulsed Drain Current ^b	-208	A
P_{D}	Power Dissipation ^c	$T_{\text{C}}=25^{\circ}\text{C}$	W
		$T_{\text{C}}=100^{\circ}\text{C}$	
P_{DSM}	Power Dissipation ^a	$T_{\text{A}}=25^{\circ}\text{C}$	W
		$T_{\text{A}}=70^{\circ}\text{C}$	
E_{AS}	Avalanche Energy ^b L=0.5mH Single Pulse	210	mJ
T_{J}	Operation junction temperature	-55~150	$^{\circ}\text{C}$
T_{STG}	Storage temperature range	-55~150	

➤ Thermal Resistance Ratings ($T_A=25^{\circ}\text{C}$ unless otherwise noted)

Symbol	Parameter	Ratings	Unit
$R_{\theta\text{JA}}$	Junction-to-Ambient Thermal Resistance ^a	30	$^{\circ}\text{C}/\text{W}$
$R_{\theta\text{JC}}$	Junction-to-Case Thermal Resistance	2	

Note:

- The value of $R_{\theta\text{JA}}$ is measured with the device mounted on 1 in² FR-4 board with 2oz.copper, in a still air environment with $T_A=25^{\circ}\text{C}$. The value in any given application depends on the user is specific board design. The power dissipation is based on the $t \leq 10\text{s}$ thermal resistance rating.
- Repetitive rating, pulse width limited by junction temperature.
- The power dissipation P_{D} is based on $T_{\text{J(MAX)}}=150^{\circ}\text{C}$, using junction-to-case thermal resistance, and is more useful in setting the upper dissipation limit for cases where additional heat sinking is used.
- The maximum current rating is package limited.



➤ **Electrical Characteristics (T_A=25°C unless otherwise noted)**

Parameter	Symbol	Test Conditions	Min.	Typ.	Max.	Unit
Drain-Source Breakdown Voltage	V _{(BR)DSS}	V _{GS} = 0V, I _D = -250μA	-30			V
Gate Threshold Voltage	V _{GS(th)}	V _{DS} = V _{GS} , I _D = -250uA	-1	-1.6	-3	V
Drain-Source On-Resistance	R _{DS(on)}	V _{GS} = -10V, I _D = -10A		12	16	mΩ
		V _{GS} = -4.5V, I _D = -7A		15	20	
Zero Gate Voltage Drain Current	I _{DSS}	V _{DS} = -30V, V _{GS} = 0V			-1	μA
Gate-Source Leak Current	I _{GSS}	V _{GS} = ±20V, V _{DS} = 0V			±100	nA
Transconductance	G _{FS}	V _{DS} = -5V, I _D = -10A		18		s
Forward Voltage	V _{SD}	V _{GS} = 0V, I _S = -10A		-0.8	-1.3	V
Input Capacitance	C _{ISS}	V _{DS} = -15V, V _{GS} = 0V, f = 1MHz		2030		pF
Output Capacitance	C _{OSS}			275		
Reverse Transfer Capacitance	C _{RSS}			243		
Total Gate Charge	Q _G	V _{GS} = -4.5V, V _{DS} = -15V, I _D = -7A		14		nC
Gate to Source Charge	Q _{GS}			4.4		
Gate to Drain Charge	Q _{GD}			2.7		
Turn-on Delay Time	T _{D(ON)}	V _{GS} = -10V, V _{DS} = -15V, R _L = 1.5Ω, R _G = 3Ω		8.6		ns
Rise Time	T _r			6		
Turn-off Delay Time	T _{D(OFF)}			39		
Fall Time	T _f			15		



➤ Typical Performance Characteristics ($T_A=25^\circ\text{C}$ unless otherwise noted)

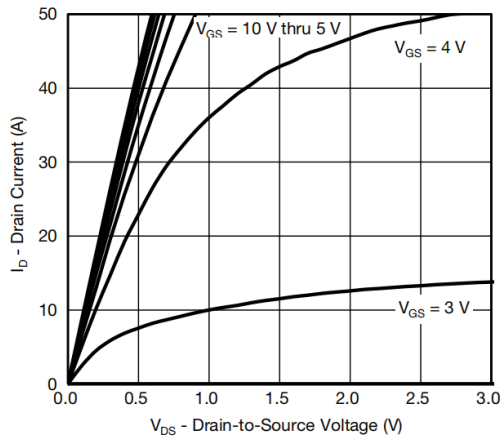

Output Characteristics

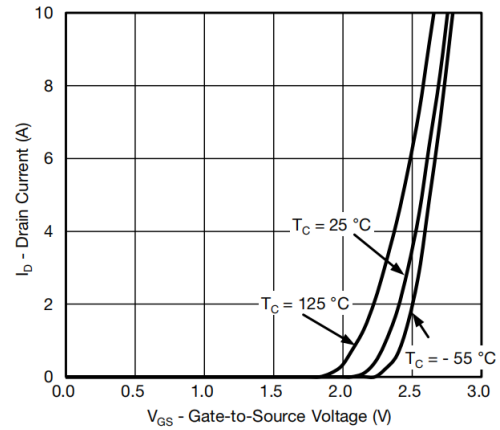

Transfer Characteristics

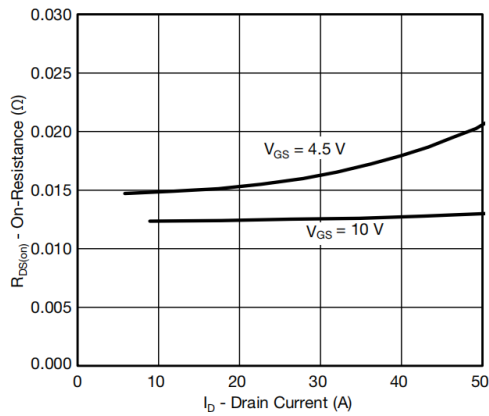

On-Resistance vs. Drain Current

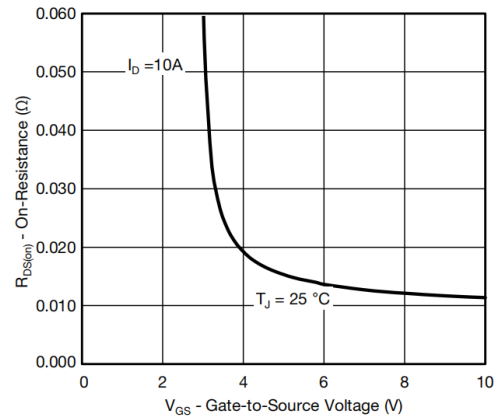

On-Resistance vs. Gate-to-Source Voltage

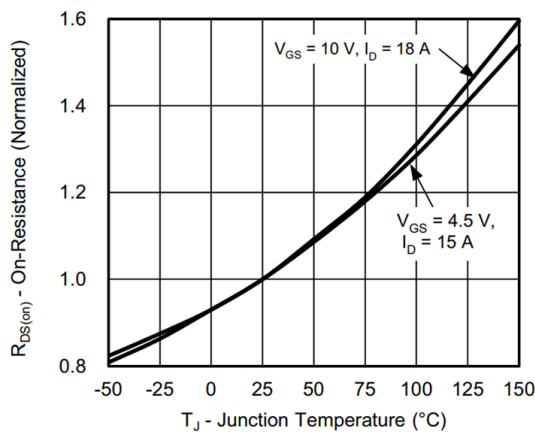

On-Resistance vs. Junction Temperature

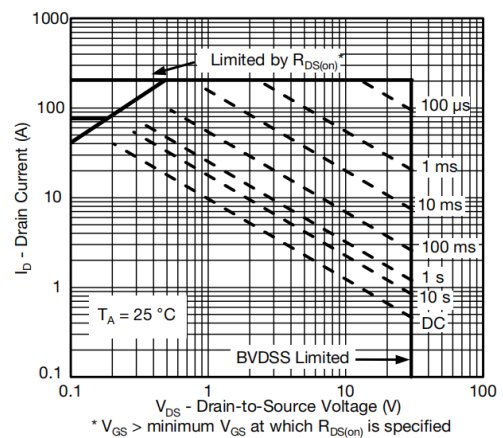

Safe Operating Area

➤ Package Information

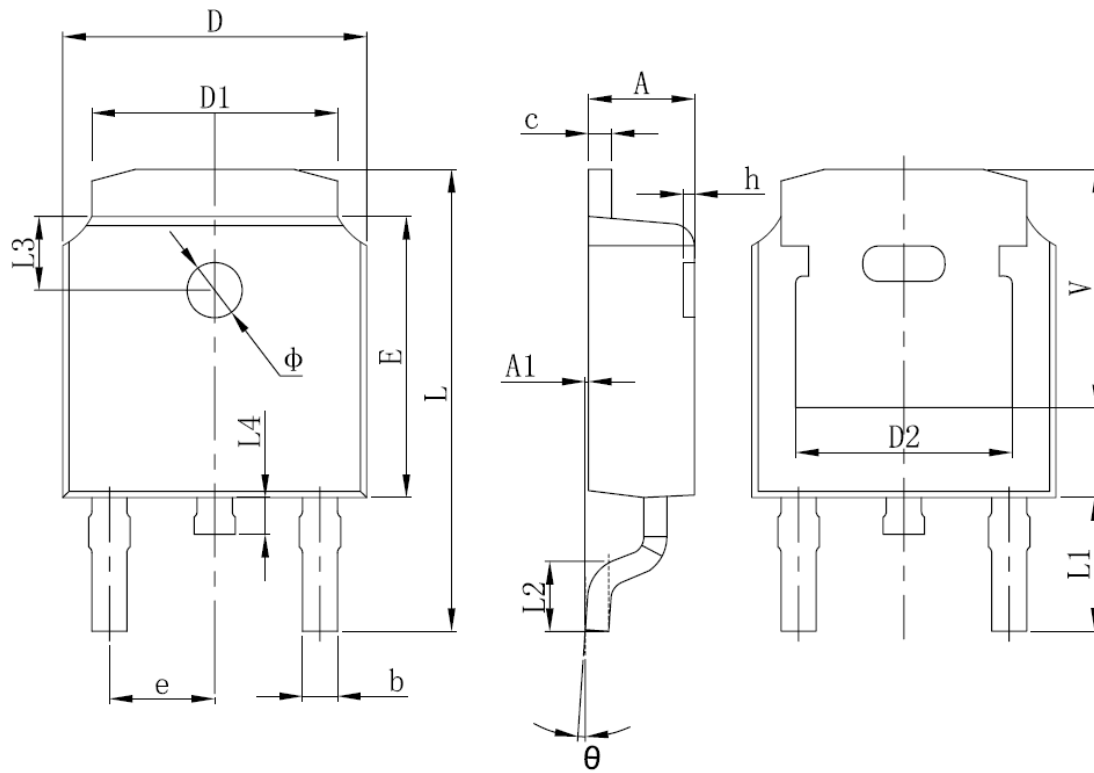

Symbol	Dimensions In Millimeters		Dimensions In Inches	
	Min.	Max.	Min.	Max.
A	2.200	2.400	0.087	0.094
A1	0.000	0.127	0.000	0.005
b	0.635	0.770	0.025	0.030
c	0.460	0.580	0.018	0.023
D	6.500	6.700	0.256	0.264
D1	5.100	5.460	0.201	0.215
D2	4.830 REF.		0.190 REF.	
E	6.000	6.200	0.236	0.244
e	2.186	2.386	0.086	0.094
L	9.712	10.312	0.382	0.406
L1	2.900 REF.		0.114 REF.	
L2	1.400	1.700	0.055	0.067
L3	1.600 REF.		0.063 REF.	
L4	0.600	1.000	0.024	0.039
Φ	1.100	1.300	0.043	0.051
θ	0°	8°	0°	8°
h	0.000	0.300	0.000	0.012
V	5.250 REF.		0.207 REF.	



DISCLAIMER

SSCSEMI RESERVES THE RIGHT TO MAKE CHANGES WITHOUT FURTHER NOTICE TO ANY PRODUCTS HEREIN TO IMPROVE RELIABILITY, FUNCTION OR DESIGN. SSCSEMI DOES NOT ASSUME ANY LIABILITY ARISING OUT OF THE APPLICATION OR USE OF ANY PRODUCT OR CIRCUIT DESCRIBED HEREIN; NEITHER DOES IT CONVEY ANY LICENCE UNDER ITS PATENT RIGHTS, NOR THE RIGHTS OF OTHERS.

THE GRAPHS PROVIDED IN THIS DOCUMENT ARE STATISTICAL SUMMARIES BASED ON A LIMITED NUMBER OF SAMPLES AND ARE PROVIDED FOR INFORMATIONAL PURPOSE ONLY. THE PERFORMANCE CHARACTERISTICS LISTED IN THEM ARE NOT TESTED OR GUARANTEED. IN SOME GRAPHS, THE DATA PRESENTED MAY BE OUTSIDE THE SPECIFIED OPERATING RANGE (E.G. OUTSIDE SPECIFIED POWER SUPPLY RANGE) AND THEREFORE OUTSIDE THE WARRANTED RANGE.

OUR PRODUCT SPECIFICATIONS ARE ONLY VALID IF OBTAINED THROUGH THE COMPANY'S OFFICIAL WEBSITE, CRM SYSTEM, OR OUR SALES PERSONNEL CHANNELS. IF CHANGES OR SPECIAL VERSIONS ARE INVOLVED, THEY MUST BE STAMPED WITH A QUALITY SEAL AND MARKED WITH A SPECIAL VERSION NUMBER TO BE VALID.